

# Hydraulic Caliper Disc Brakes BACW 100



**B**



**PINTSCH BUBENZER**  
is certified according to  
DIN EN ISO 9001:2000

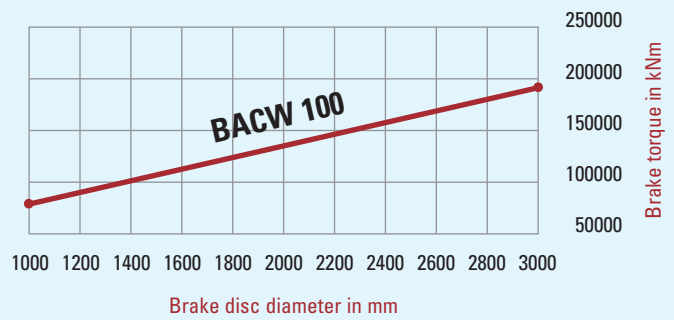

Reliable



High Performance



Robust Design



Easy Maintenance

# Description BACW 100



## Main Features

- Brake hydraulic applied, spring released
- No failsafe function!**
- Organic, non-asbestos linings
- Airgap between brake pad and disc up to 2 mm per side

## Options

- Pad Retraction Springs for dynamically Applications
- Sintered linings
- Complete piped supports for one or more calipers
- Hydraulic power units
- Brake discs

## Applications

- YAW Brake Systems



### Please Note

We supply a detailed operating manual with every order. Nevertheless, we would point out that brakes are only as safe as the servicing and maintenance performed while they are in operation. The guarantee for the correct functioning of our brakes is therefore only valid if the user adheres to the German DIN standard 15434 part 2 (drum and disc brakes, servicing and maintenance in operation), or to comparable standards in his own country.



### PINTSCH BUBENZER Service

This includes the verification of the brake selection, if required. A detailed questionnaire is provided for this purpose. Installation and commissioning on site is possible by PINTSCH BUBENZER service engineers. Drawings as DWG/DXF files for your engineering department are available upon request.

# Disc Brake BACW 100

Dimensions and technical data



Rev. 05-08

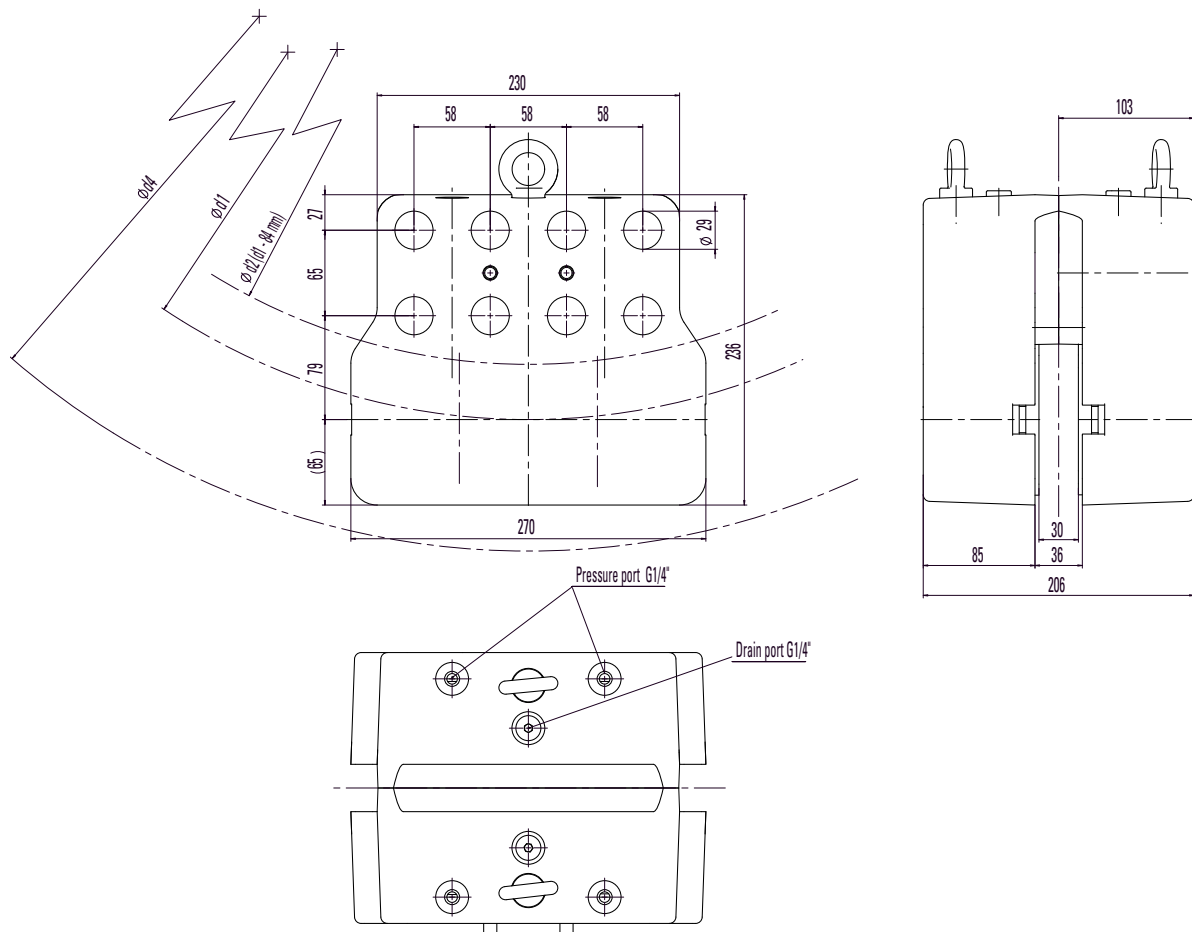

**B**

Type BACW 100		
Contact Force $F_A$	kN	200
Operating Pressure (max.)	bar	160
Oil Volume – 1 mm Stroke	l	0.051
Piston Area (per Side)	cm <sup>2</sup>	127.2
Temperature Range	°C	-20 to +60
Weight	kg	60

Brake Pad		
Pad Area (each Side)	cm <sup>2</sup>	230
Brake Pad Width	mm	116
Theor. Friction Coefficient *	$\mu$	0,4

Brake Disc		
Brake Disc $\varnothing d_2$	mm	1.000
Disc Thickness (Standard)	mm	40

\*) Average friction factor of standard material combination

All dimensions in mm  
Alterations reserved without notice